

Spring Latch Series 713

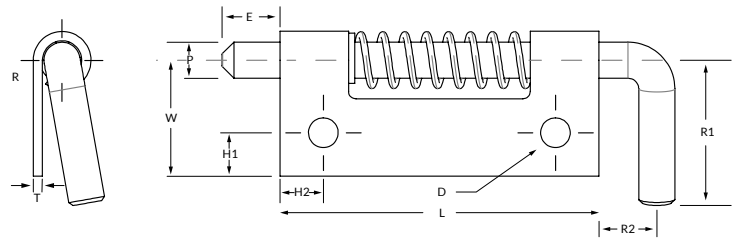

PIN

P	Pin Diameter	.187
*	E Extension	.375
*	R1 Handle Length	.687
*	R2 Handle Extension	.312

BODY

L	Length	2.000
*	W Width A	.625
	Width B	.875
T	Thickness	.050
*	H1 Hole Location	.187
*	H2 Hole Location	.250

MATERIAL

	Steel	Stainless	Aluminum
Designation	S	C	A
Pin Type	12L14	303	SS
Body	1010	304	5052
Spring	302	302	302
C-Ring	PH15-7 MO	PH15-7 MO	PH15-7 MO

MODEL

R	Right Handed
L	Left Handed
U	Unassembled

POINT STYLE

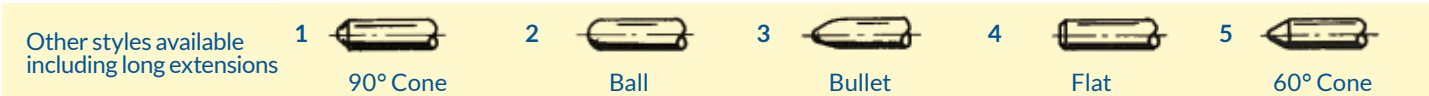

FINISH

Most commercial finishes are available including zinc plate on steel, passivate and electropolishing on stainless steel, and anodize on aluminum.

ORDERING INFORMATION

Sample Part #
713 - C L B 3 - N.H. - Electropolish

Basic Part No. → 713
 Material (Stainless Steel) → C
 Model (Left Hand) → L
 Body Width (.875) → B
 Point Style (Bullet) → 3
 No Holes → N.H.
 Finish → Electropolish

*Designates dimensions that can be altered to meet your specifications.