

Spring Latch Series 712

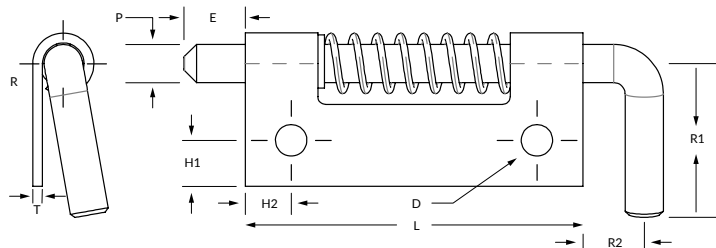

PIN

P	Pin Diameter	.156	
*	E	Extension	.250
*	R1	Handle Length	.625
*	R2	Handle Extension	.250

BODY

L	Length	1.375	
*	W	Width A	.500
		Width B	.750
T	Thickness	.040	
*	H1	Hole Location	.187
*	H2	Hole Location	.187

MATERIAL

	Steel	Stainless	Aluminum
Designation	S	C	A
Pin Type	12L14	303	SS
Body	1010	304	5052
Spring	302	302	302
C-Ring	PH15-7 MO	PH15-7 MO	PH15-7 MO

MODEL

R	Right Handed
L	Left Handed
U	Unassembled

POINT STYLE

Other styles available including long extensions

1



90° Cone

2

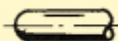

Ball

3



Bullet

4



Flat

5



60° Cone

FINISH

Most commercial finishes are available including zinc plate on steel, passivate and electropolishing on stainless steel, and anodize on aluminum.

ORDERING INFORMATION

Sample Part

712 - C L B 3 - N.H. - Electropolish

Basic Part No.	712	Material (Stainless Steel)	C	Model (Left Hand)	L	Body Width (.750)	B	Point Style (Bullet)	3	Finish	Electropolish
								No Holes	N.H.		

*Designates dimensions that can be altered to meet your specifications.