

Slam Latch Series 709

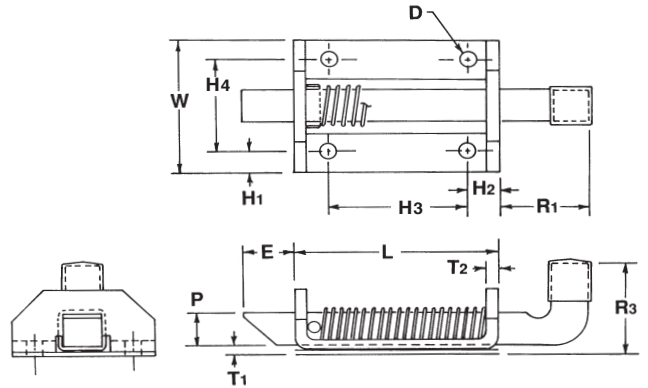
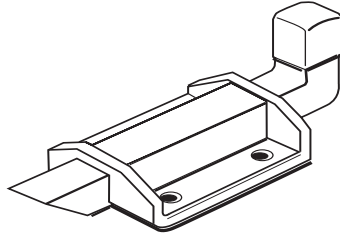

Available in 3 sizes:
7/16", 3/8" and 1/2" pins.
These rugged latches
are ideal for doors,
drawers, truck/trailer
bodies, construction, farm
equipment and all aircraft
applications.

PIN (01)

P	Pin Size	.500
* E	Extension	.750
R1	Handle Length	1.250
R3	Handle Extension	1.375

BODY (02)

L	Length	2.875
* W	Width	2.000
T1	Thickness	.190
T2	Thickness	.190
* H1	Hole Location	.312
* H2	Hole Location	.468
H3	Hole Location	1.930
H4	Hole Location	1.375
* D	Hole Diameter	.265

MATERIAL

C = Stainless S = Steel

FINISH

Most commercial finishes are available, including zinc and cadmium on steel, passivate and electropolishing on stainless steel.

ORDERING INFORMATION

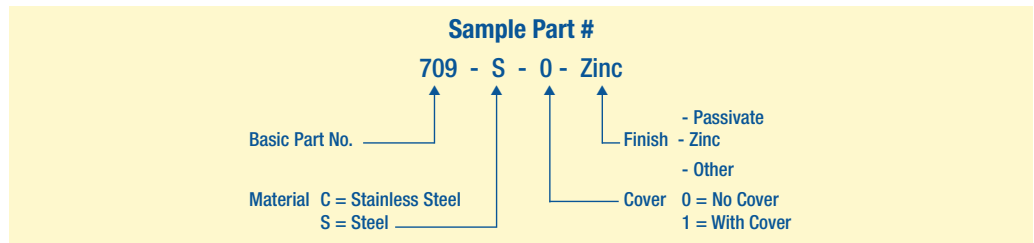

Special forms, offsets, hole sizes or welding projections are available to your specifications.

*Designated dimensions can be altered to meet your specifications.